



SINCE MORE THAN 20 YEARS, THE VETEDY GROUP HAS SPECIALISED IN THE PRODUCTION AND DISTRIBUTION OF EXOTIC TIMBERS, BOTH FOR OUTDOOR GARDEN DECKING AND INDOOR FLOORING.

VETEDY Group has grown at an incredible rate, thanks mainly to its revolutionary *Softline*<sup>®</sup> system which enables exterior decking to be fitted with no visible screws or oxidation.

VETEDY is an international group located in Luxembourg, Belgium, Cameroon and Indonesia and is represented the world over by its network of distributors.

The Wood flooring for the Garden is remarkable as it represents great strides forward. We are the inventors and sole manufacturers of the exclusive *Softline*<sup>®</sup> system, - a patented exterior flooring system (EP 1567731) with invisible fixings using timbers that are both extremely rot-resistant and very stable. Our experience and research have now provided some long-awaited answers to often raised questions.

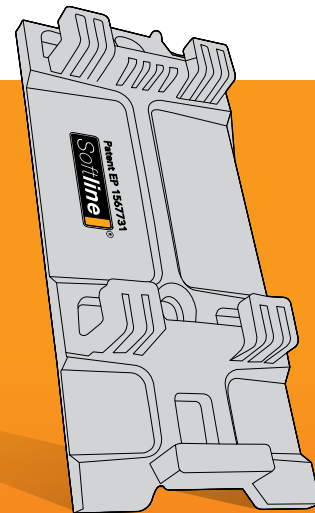

**CONTACT**

Tel. : (+352) 26 30 61-1  
Fax : (+352) 26 30 61-61  
info@vetedy.com

**VETEDY LUXEMBOURG S.A.**

39 route d'Arlon  
L-8410 STEINFORT  
GRAND DUCHY OF LUXEMBOURG

**VETEDY BELGIUM S.A.**

50 zone artisanale  
de Weyler  
B-6700 ARLON  
BELGIUM

**VETEDY CAMEROUN S.À R.L.**

BP 4363 NLONGKAK  
YAOUNDE  
CAMEROON

**PT VETEDY INDONESIA**

Jl. Bukit Darmo Boulevard  
Office Park 2 B2 No. 11  
SURABAYA INDONESIA

[www.vetedy.com](http://www.vetedy.com)

It is an international organization composed of organizations' representatives of environmental protection, organizations defending the rights of indigenous peoples, forest and wood products dealers. By adhering to this charter, the Vetedy Group affirms its commitment to ensuring the preservation of our nature and attaches particular attention to respect for the rational management of natural resources and the equitable distribution of income in the country of production.



**INVISIBLE. UNBREAKABLE. ROT-PROOF.**

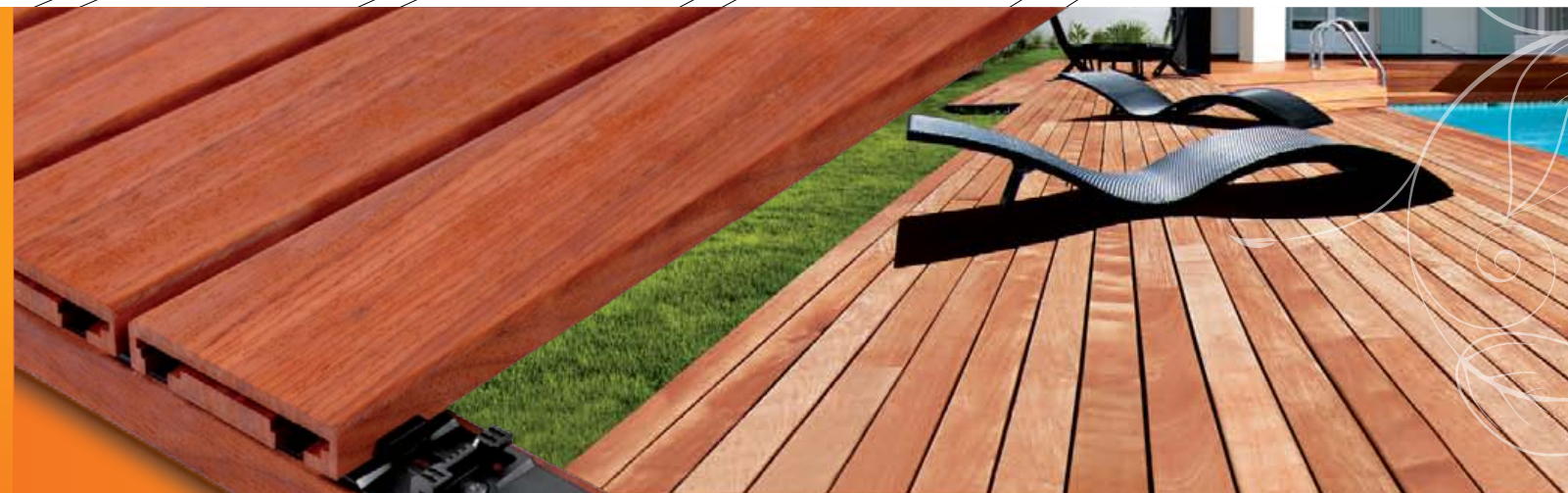

*Softline*<sup>®</sup>, A REVOLUTIONARY SYSTEM OF WOOD DECKING FOR THE GARDEN AND AROUND SWIMMING POOLS WITH INVISIBLE FIXATION.





## THE FIXATION. INVISIBLE. UNBREAKABLE.

The fixation is a revolutionary system enabling the installation of planks without any apparent screw, improving both the resistance of the structure (no more weak points in the plank or in shearing the screw) and gives perfectly homogeneous aesthetics.

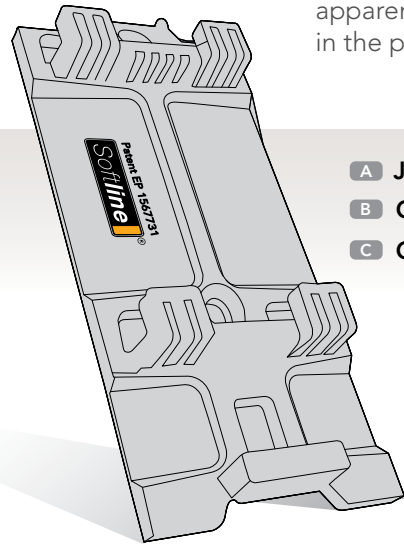

- A Joist
- B Clip
- C Grooved wooden board

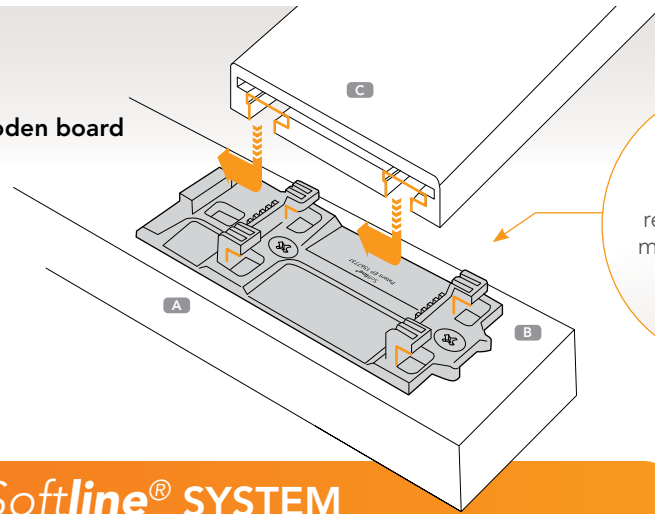

This system, designed in very resistant composite material, guarantees long-lasting durability.

### THE ADVANTAGES OF *Softline*® SYSTEM

- Enables invisible fixation to the support.
- Composite material with high mechanical strength, guaranteeing a high quality system.
- Flexibility in compression and/or expansion, allowing re-positioning after stress (unlike steel).
- Eliminates the stage of pre-drilling and countersinking.
- Allows lateral movement between the planks without any resulting deterioration of the wood.
- Allows the strips to be isolated from the support.
- Provides a guarantee of long-lasting durability.
- Shortens the installation time.
- Allows even jointing between strips.
- Prevents the twist in the planks.
- Ensures free circulation of air.
- Reinforces the general aspect thank to a wooden frame fixed with non visible screws.
- Allow a vertical installation (facade, fence, planter,...).
- Possibility of removing and replacing planks.

The *Softline*® fixation system allows free circulation of air and movement between the planks without any resulting deterioration of the wood.

In order to guarantee a perfect assembling with our *Softline*® system, we mould the specific grooves, with a machine specially designed for this purpose, in our workshop.

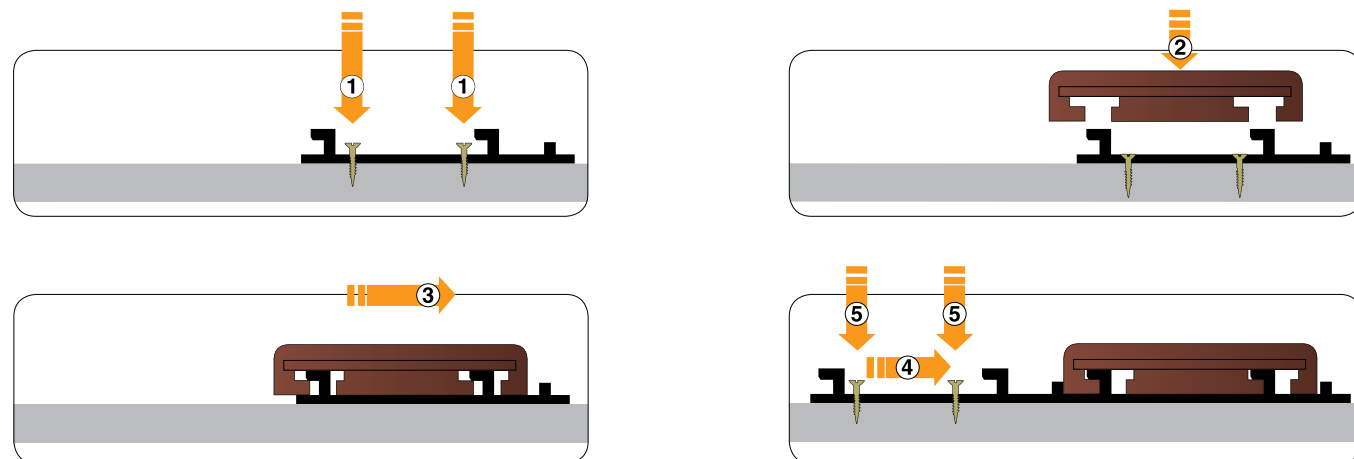

## THE WOOD. ROT-PROOF. STABLE.

Our exceptional varieties of wood: **Padauk, Merbau, Ipe, Teak** have been chosen for their technical properties, perfectly suited to the most varied and most variable of climatic conditions.

Our products are dried to an average moisture content of 13% (+/- 2%) and are perfectly rot-proof without any chemical treatment and very stable regardless of the external conditions.

**Padauk**, african specy has been specially chosen for its exceptional technical qualities and its contemporary shades and tone. It is produced in Cameroon.

The Asian finishes are sourced from Indonesia for **Merbau** and Myanmar for **Teak**.

**Ipe** comes from the Amazon forest in South America.

All our production from different continents is carefully selected and controlled by our company.

### THE WOOD PROFILE IS OFFERED IN A SINGLE SIZE

20 x 100 x 2400/2000 mm (Main length) or 20 x 96 x 2400/2000 mm for Teak, and can be fixed with the *Softline*® invisible fixation system.

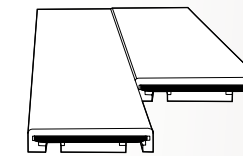

### TONGUE IN COMPOSITE MATERIAL

Ensures perfect junction between two strips.

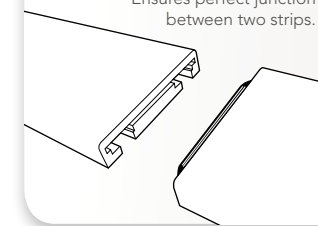

### OUR SELECTED WOODEN SPECIES

WOODEN SPECIES	NATURAL ASPECT	ASPECT AFTER SIX MONTHS (WITHOUT ANY TREATMENT)
Padauk		
Merbau		
Ipe		
Teak		

Our permanent stock enables us to ensure fast distribution to the majority of European destinations.



THE *Softline*® SYSTEM COMBINES ALL REQUIREMENTS CONCERNING BOTH RELIABILITY AND AESTHETICS.

### THE ADVANTAGES OF THE WOOD

- Class I rot-proof wood.
- Very stable wood, oven-dried, guaranteeing very little distortion.
- Selected high-grade wood.
- Smooth anti-slip surface, without splinters.
- Wood without any need for preliminary treatment.
- Planks of fixed lengths, precision cut, avoiding on-site trimming.
- Pleasant material, never too hot, never too cold.

